

Std. Dwg. No.	Descriptions
P-0010 P-0012 P-0013 P-0014 P-0015	<p style="text-align: center;">BIKEWAYS</p> <p>BIKEPATH</p> ENTRANCE TO ROAD RESERVE PAVEMENT JOINTS SLOWDOWN CONTROL, REVERSE CURVE SLOWDOWN CONTROL, Z CHICANE SLOWDOWN CONTROL, OFFSET CHICANE

A	ORIGINAL ISSUE	8/12/95
	REVISIONS	DATE



Whitsunday
Regional Council

Email: info@whitsundayrc.qld.gov.au Web: www.whitsundayrc.qld.gov.au

BOWEN
67 Herbert St
Bowen 4805 Q
Ph 07 4761 3600

COLLINSVILLE
Cnr Stanley & Conway Sts
Collinsville 4804 Q
Ph 07 4785 5366

PROSERPINE
83-85 Main St
Proserpine 4800 Q
Ph 07 4945 0200

INDEX
STANDARD DRAWINGS
PARKS

PARKS
Standard
Drawing
P-0001

A				
---	--	--	--	--

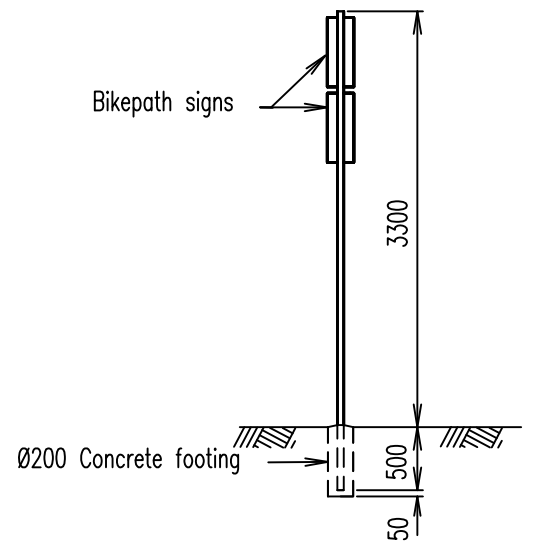

SIGN POST DETAIL

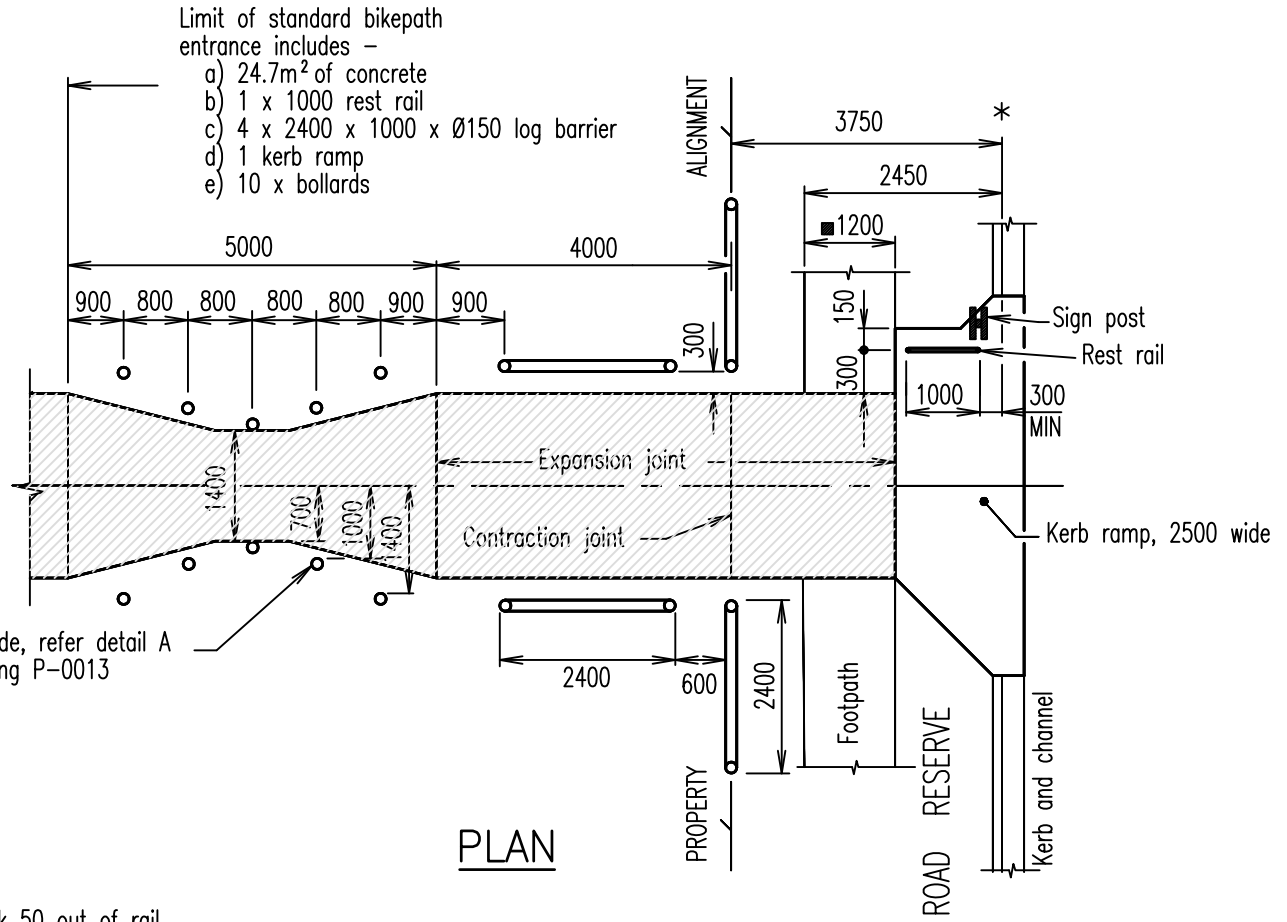

PLAN

5 bollards each side, refer detail A on Standard Drawing P-0013

- Limit of standard bikepath entrance includes -
- a) 24.7m² of concrete
 - b) 1 x 1000 rest rail
 - c) 4 x 2400 x 1000 x Ø150 log barrier
 - d) 1 kerb ramp
 - e) 10 x bollards

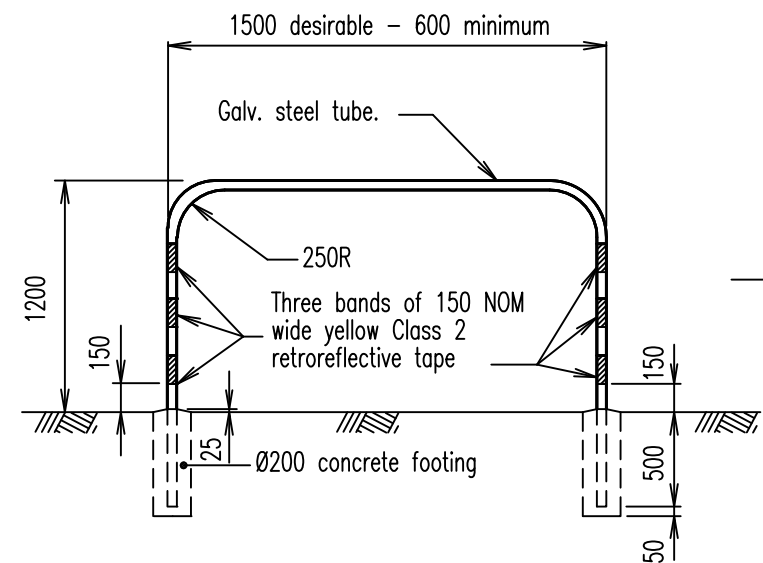

REST RAIL DETAIL

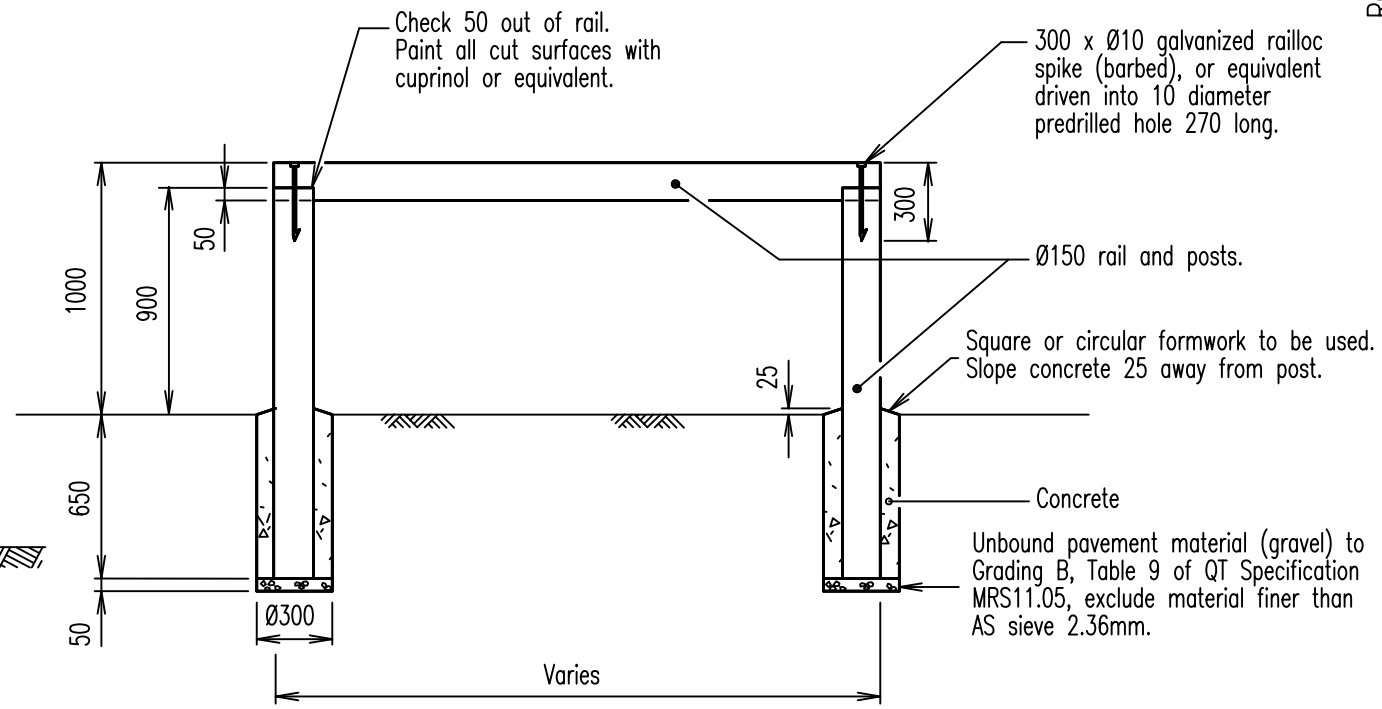

LOG BARRIER FENCE DETAIL

LEGEND

- Unless otherwise specified
- * NOM kerb line

NOTES

1. Concrete N25 in accordance with AS 1379 and AS 3600.
2. Concrete slab to be 100mm thick, refer Standard Drawing P-0012.
3. C.C.A. log barriers to be Ø150, Grade A superlogs or equivalent.
4. Kerb ramp details as per Standard Drawing R-0084.
5. Rest rail to be 60.3 x 3.6 CHS in accordance with AS 1163/C250.
6. Galvanizing to AS 1650.
7. Clear opening in log barrier fence along the property alignment to be 4700 where a lockrail if specified.
8. The nominal 2500 bikepath width may need to be increased for high use areas.
9. All dimensions in millimetres.

A	ORIGINAL ISSUE	8/12/95
	REVISIONS	DATE



Email: info@whitsundayrc.qld.gov.au Web: www.whitsundayrc.qld.gov.au

BOWEN
67 Herbert St
Bowen 4805 Q
Ph 07 4761 3600

COLLINSVILLE
Cnr Stanley & Conway Sts
Collinsville 4804 Q
Ph 07 4785 5366

PROSERPINE
83-85 Main St
Proserpine 4800 Q
Ph 07 4945 0200

**BIKEPATH
ENTRANCE TO ROAD RESERVE**

**PARKS
Standard
Drawing
P-0010**

A			
---	--	--	--

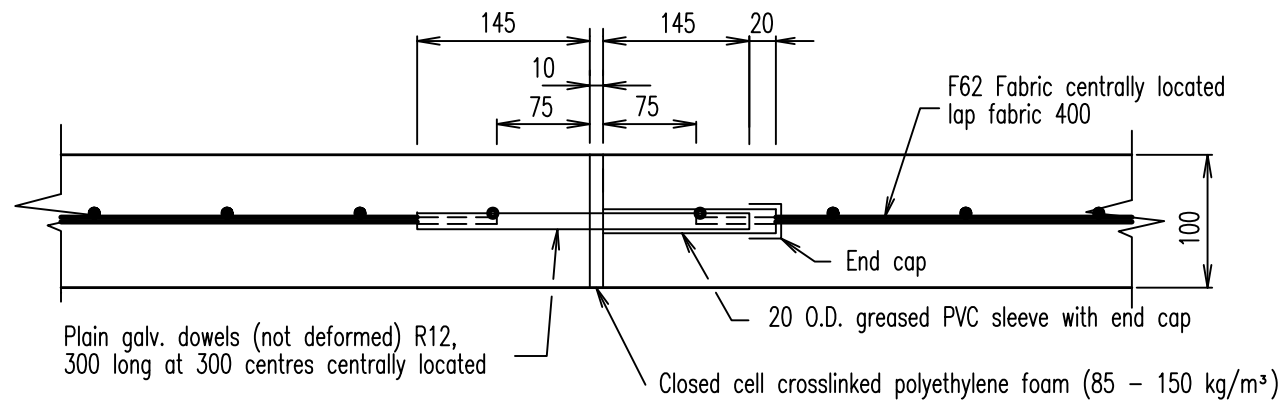

EXPANSION JOINT
Spacing 16m

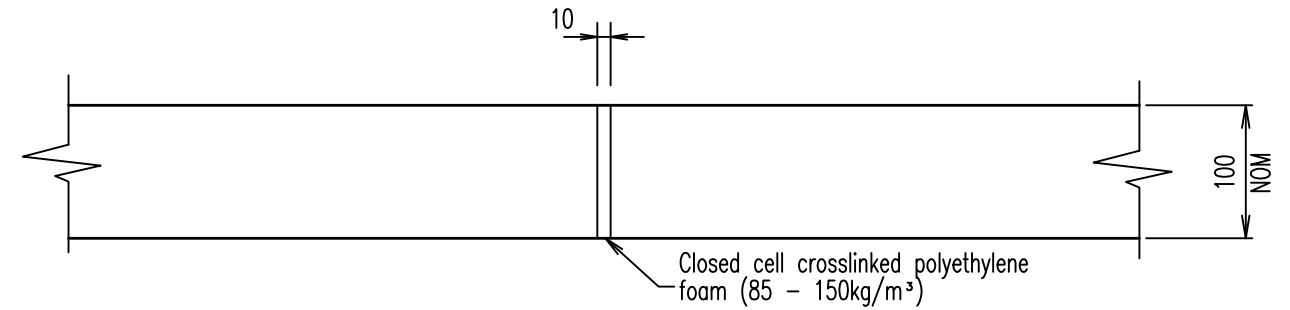

EXPANSION JOINT
Spacing 16m

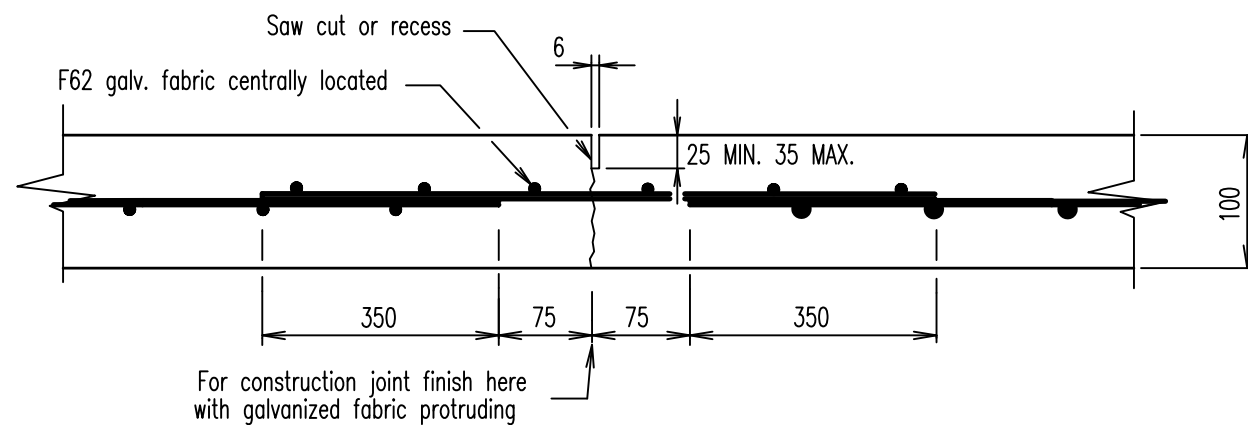

CONTRACTION JOINT
Spacing 4m

REINFORCED

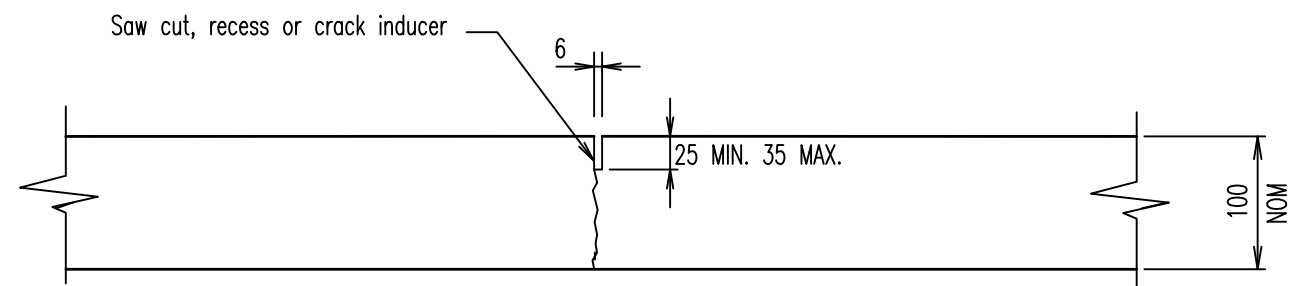

CONTRACTION JOINT
Spacing 2m

NON REINFORCED

NOTES:

1. Concrete N25 in accordance with AS 1379 and AS 3600.
2. Reinforcement and dowels to be used, if specified, when bikepath is placed on fill or on poor subgrade.
3. Bikepath thickness may be reduced to 75mm in good ground conditions.
4. Dowels Grade 250 steel to AS 1302. Fabric to AS 1304.
5. Galvanizing to AS 1650.
6. All dimensions in millimetres.

A	ORIGINAL ISSUE	8/12/95
	REVISIONS	DATE



Whitsunday
Regional Council

Email: info@whitsundayrc.qld.gov.au Web: www.whitsundayrc.qld.gov.au

BOWEN
67 Herbert St
Bowen 4805 Q
Ph 07 4761 3600

COLLINSVILLE
Cnr Stanley & Conway Sts
Collinsville 4804 Q
Ph 07 4785 5366

PROSERPINE
83-85 Main St
Proserpine 4800 Q
Ph 07 4945 0200

BIKEPATH
PAVEMENT JOINTS

PARKS
Standard
Drawing
P-0012

A				
---	--	--	--	--

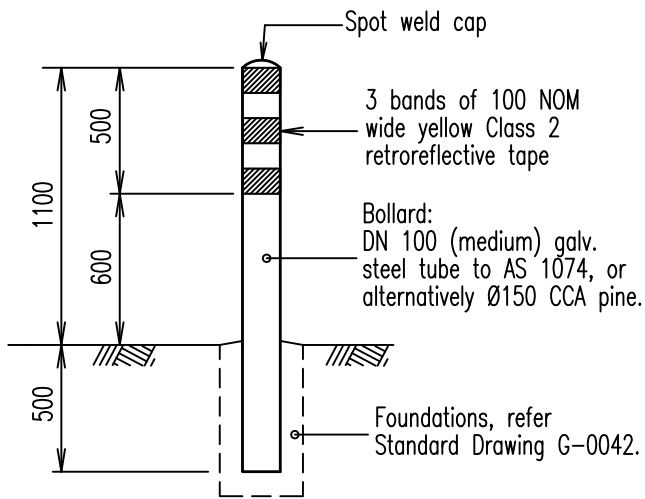

DETAIL A

- Limit of standard bikepath, entrance includes -
- a) 64.3m² of concrete
 - b) 1 x 1000 rest rail
 - c) 4 x 2400 x 1000 x Ø150 C.C.A. log barriers
 - d) 4 x 2400 x 600 and 2 x 2825 x 600 x 150 DIA C.C.A. log barriers
 - e) 10 x bollards
 - f) 1 Kerb ramp

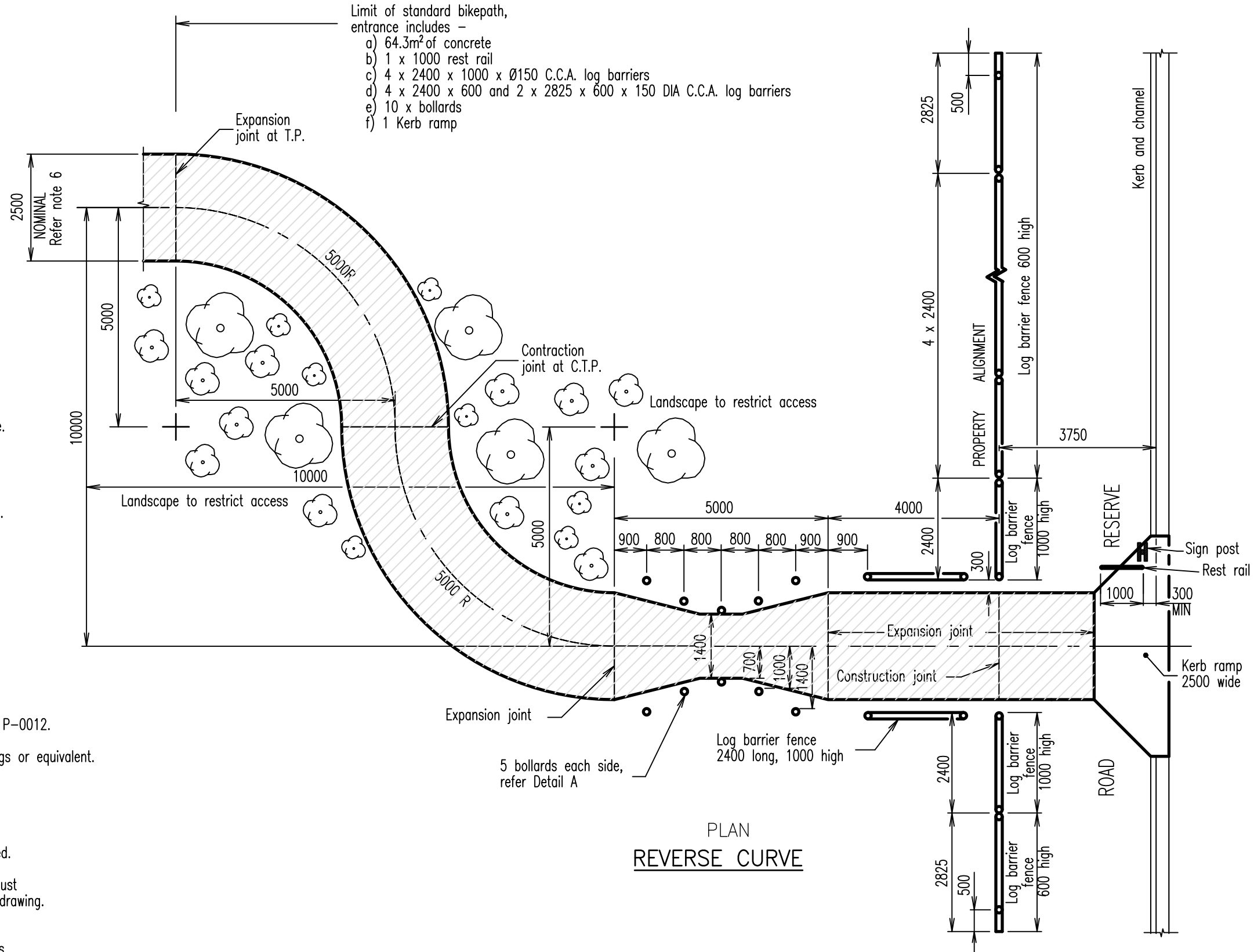

PLAN REVERSE CURVE

- NOTES
1. Concrete N25 in accordance with AS 1379 and AS 3600.
 2. Concrete slab to be 100mm thick, refer Standard Drawing P-0012.
 3. C.C.A. log barrier to be 150mm diameter, Grade A superlogs or equivalent.
 4. Kerb ramp details refer Standard Drawing R-0084.
 5. Rest rails, refer Standard Drawing P-0010.
 6. The nominal 2500 bikepath width may need to be increased.
 7. Refer Standard Drawing P-0010 for log barrier details, adjust location of posts and height to suit dimensions on this drawing.
 8. Retroreflective tape to AS/NZS 1906.1. Apply in accordance with manufacturer's recommendations.
 9. All dimensions in millimetres.

A	ORIGINAL ISSUE	8/12/95
	REVISIONS	DATE



Email: info@whitsundayrc.qld.gov.au Web: www.whitsundayrc.qld.gov.au

BOWEN
67 Herbert St
Bowen 4805 Q
Ph 07 4761 3600

COLLINSVILLE
Cnr Stanley & Conway Sts
Collinsville 4804 Q
Ph 07 4785 5366

PROSERPINE
83-85 Main St
Proserpine 4800 Q
Ph 07 4945 0200

**BIKEPATH
SLOWDOWN CONTROL
REVERSE CURVE**

**PARKS
Standard
Drawing
P-0013**

A				
---	--	--	--	--

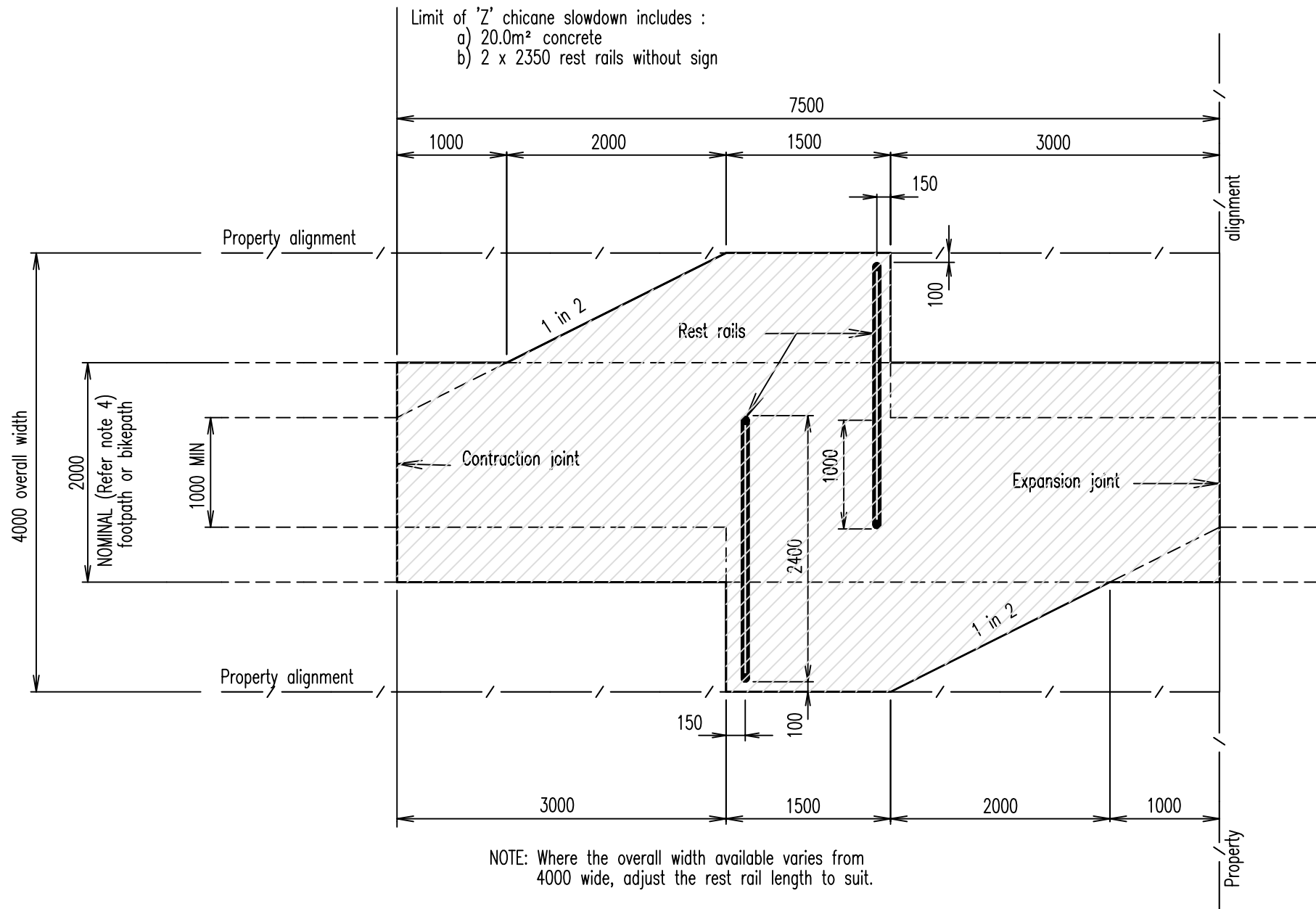

NOTE: Where the overall width available varies from 4000 wide, adjust the rest rail length to suit.

Z CHICANE

RESERVE
ROAD

NOTES :

1. Concrete N25 in accordance with AS 1379 and AS 3600.
2. Concrete slab to be 100 thick, refer Standard Drawing P-0012.
3. Rest rails refer Standard Drawing P-0010.
4. The nominal 2000 bikepath width may need to be increased for high use areas.
5. All dimensions in millimetres.

A	ORIGINAL ISSUE	8/12/95
	REVISIONS	DATE



Whitsunday
Regional Council

Email: info@whitsundayrc.qld.gov.au Web: www.whitsundayrc.qld.gov.au

BOWEN
67 Herbert St
Bowen 4805 Q
Ph 07 4761 3600

COLLINSVILLE
Cnr Stanley & Conway Sts
Collinsville 4804 Q
Ph 07 4785 5366

PROSERPINE
83-85 Main St
Proserpine 4800 Q
Ph 07 4945 0200

**BIKEPATH
SLOWDOWN CONTROL
Z CHICANE**

**PARKS
Standard
Drawing
P-0014**

A

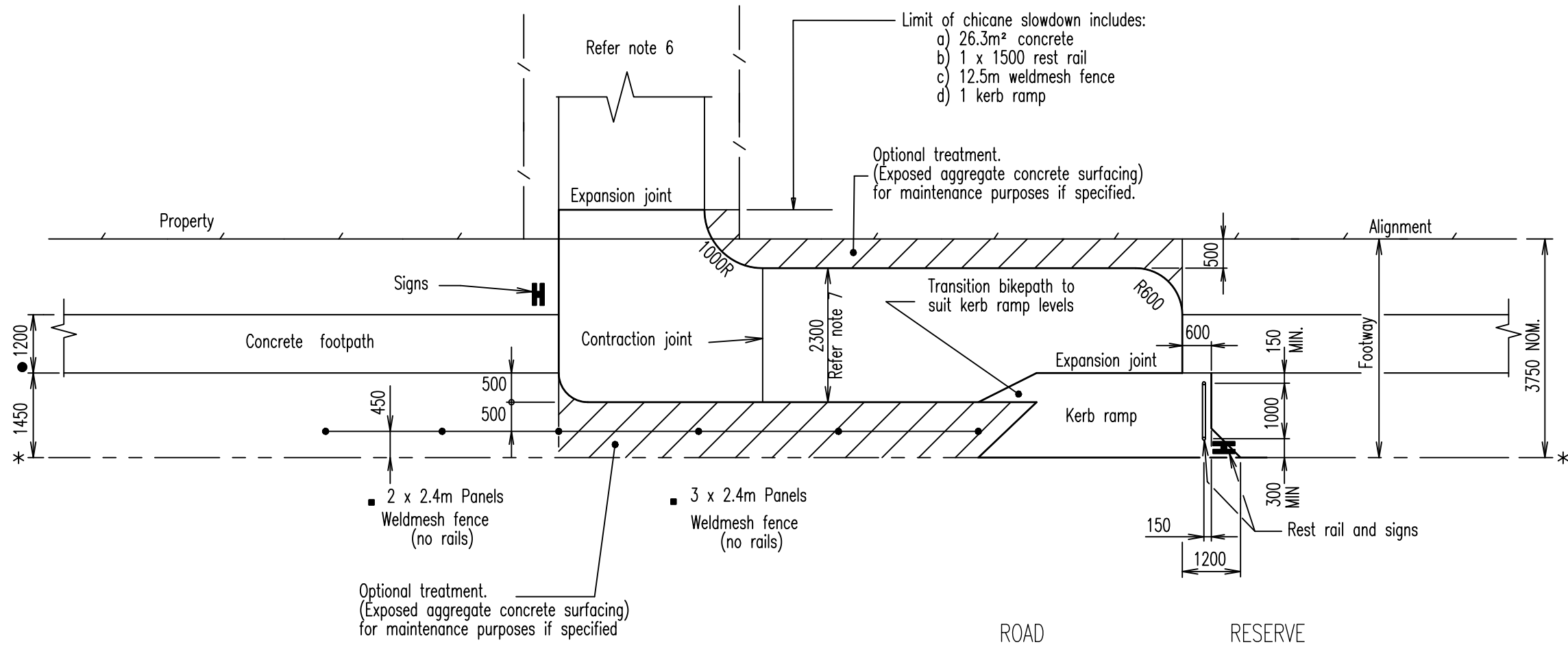

OFFSET CHICANE

- For use where reverse curve is not practical
- Recommended for areas with high primary school traffic

LEGEND

- * NOM. kerb line
- Each section may be reduced by 1 panel, refer project drawings
- Unless otherwise specified

NOTES

1. Concrete N25 in accordance with AS 1379 and AS 3600.
2. Concrete slab to be 100mm thick, refer Standard Drawing P-0012.
3. Weldmesh fence details as per Standard Drawing G-0045.
4. Kerb ramp details as per Standard Drawing R-0084.
5. Rest rails, refer Standard Drawing P-0010.
6. The NOMINAL 2500 bikepath width may need to be increased for high use areas.
7. Bikepath width may need to be reduced to suit available footway. The preferred width is 2500; the absolute minimum width is 2000.
8. All dimensions in millimetres, unless shown otherwise.

A	ORIGINAL ISSUE	8/12/95
	REVISIONS	DATE



Whitsunday
Regional Council

Email: info@whitsundayrc.qld.gov.au Web: www.whitsundayrc.qld.gov.au

BOWEN
67 Herbert St
Bowen 4805 Q
Ph 07 4761 3600

COLLINSVILLE
Cnr Stanley & Conway Sts
Collinsville 4804 Q
Ph 07 4785 5366

PROSERPINE
83-85 Main St
Proserpine 4800 Q
Ph 07 4945 0200

**BIKEPATH
SLOWDOWN CONTROL
OFFSET CHICANE**

PARKS
Standard
Drawing
P-0015

A